

This is an example of a land survey. It shows height contours, the site boundary, buildings, major trees and of course the orientation of the site. This one also shows hardstandings and a footpath. Such a survey is the basis for the design for any buildings on this site.

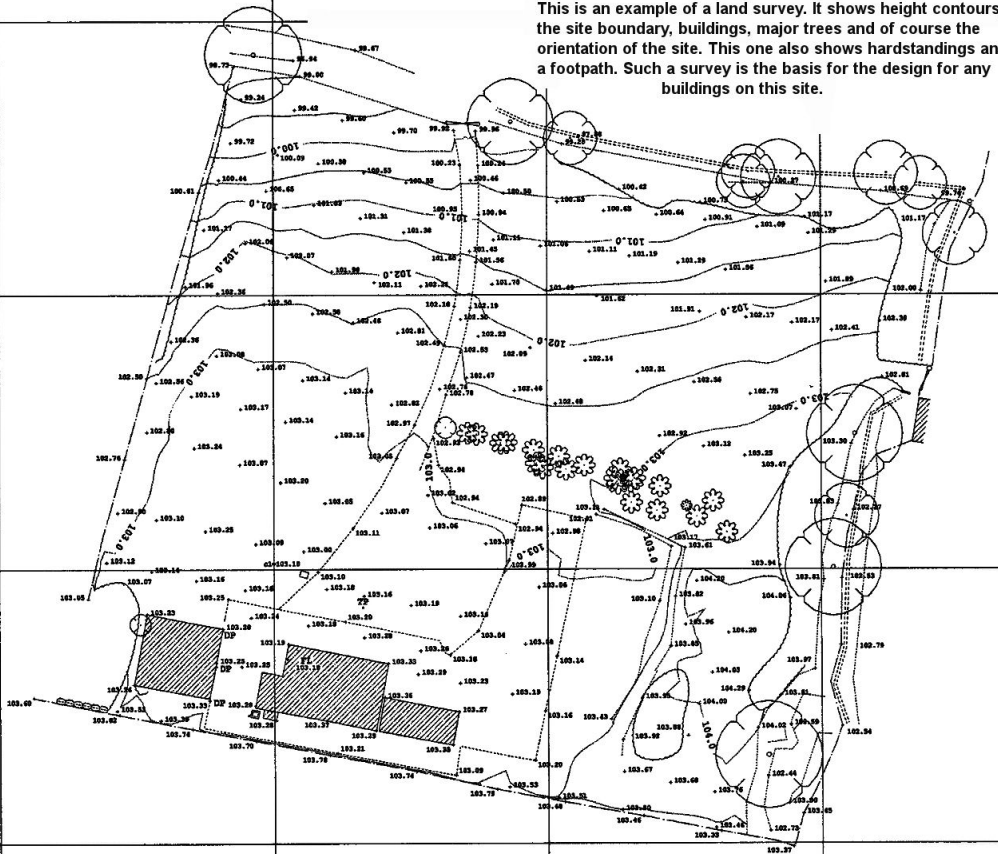

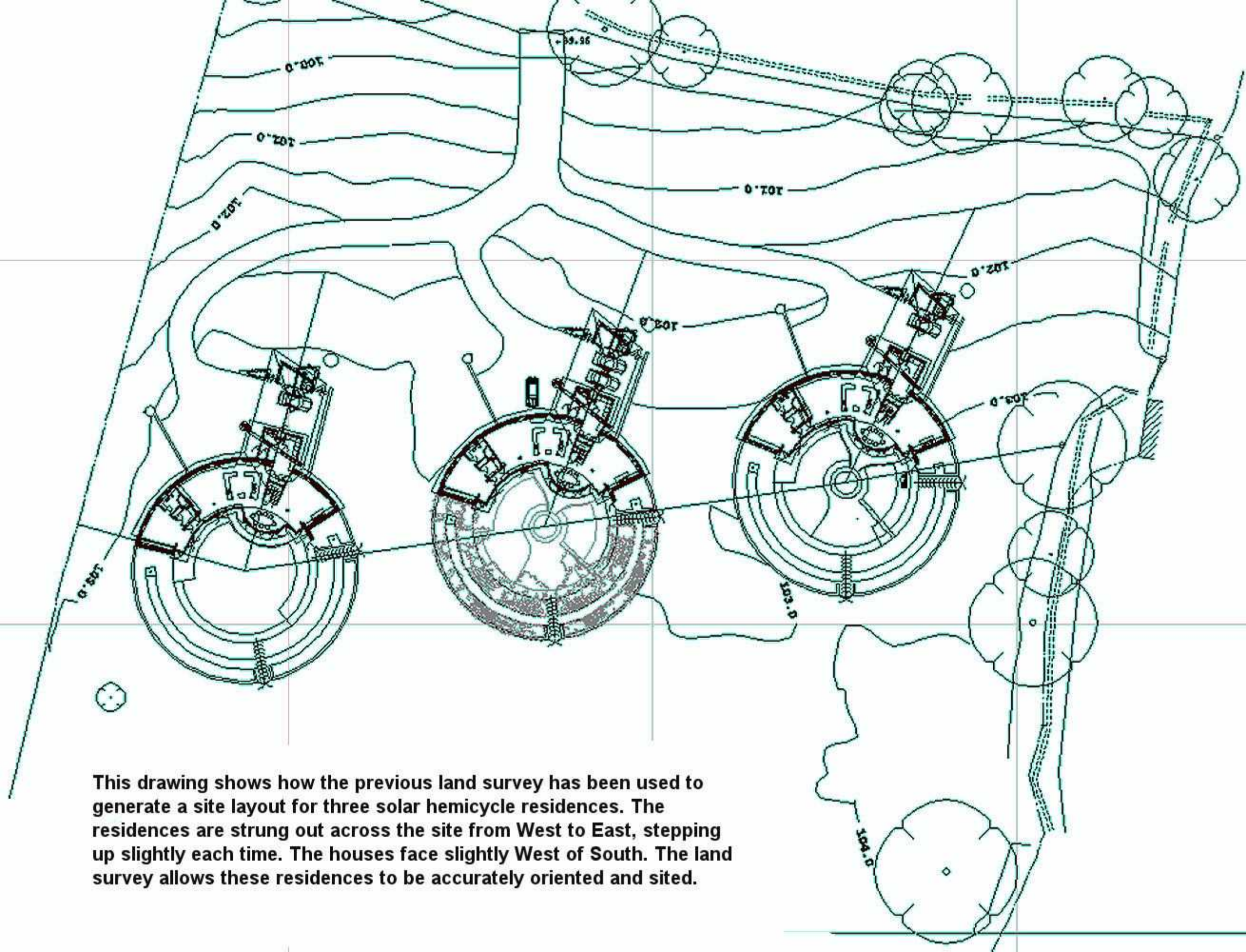

This drawing shows how the previous land survey has been used to generate a site layout for three solar hemicycle residences. The residences are strung out across the site from West to East, stepping up slightly each time. The houses face slightly West of South. The land survey allows these residences to be accurately oriented and sited.

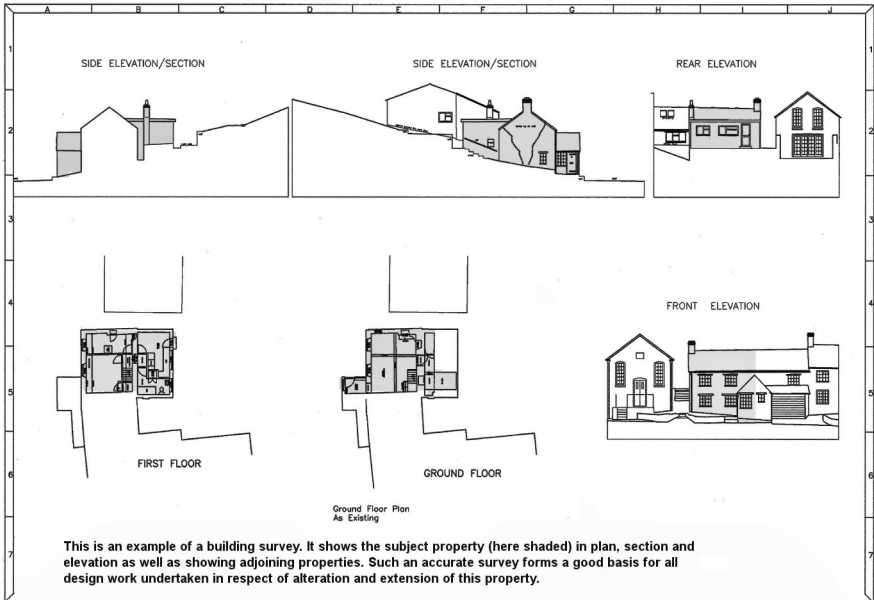

**This is an example of a building survey. It shows the subject property (here shaded) in plan, section and elevation as well as showing adjoining properties. Such an accurate survey forms a good basis for all design work undertaken in respect of alteration and extension of this property.**

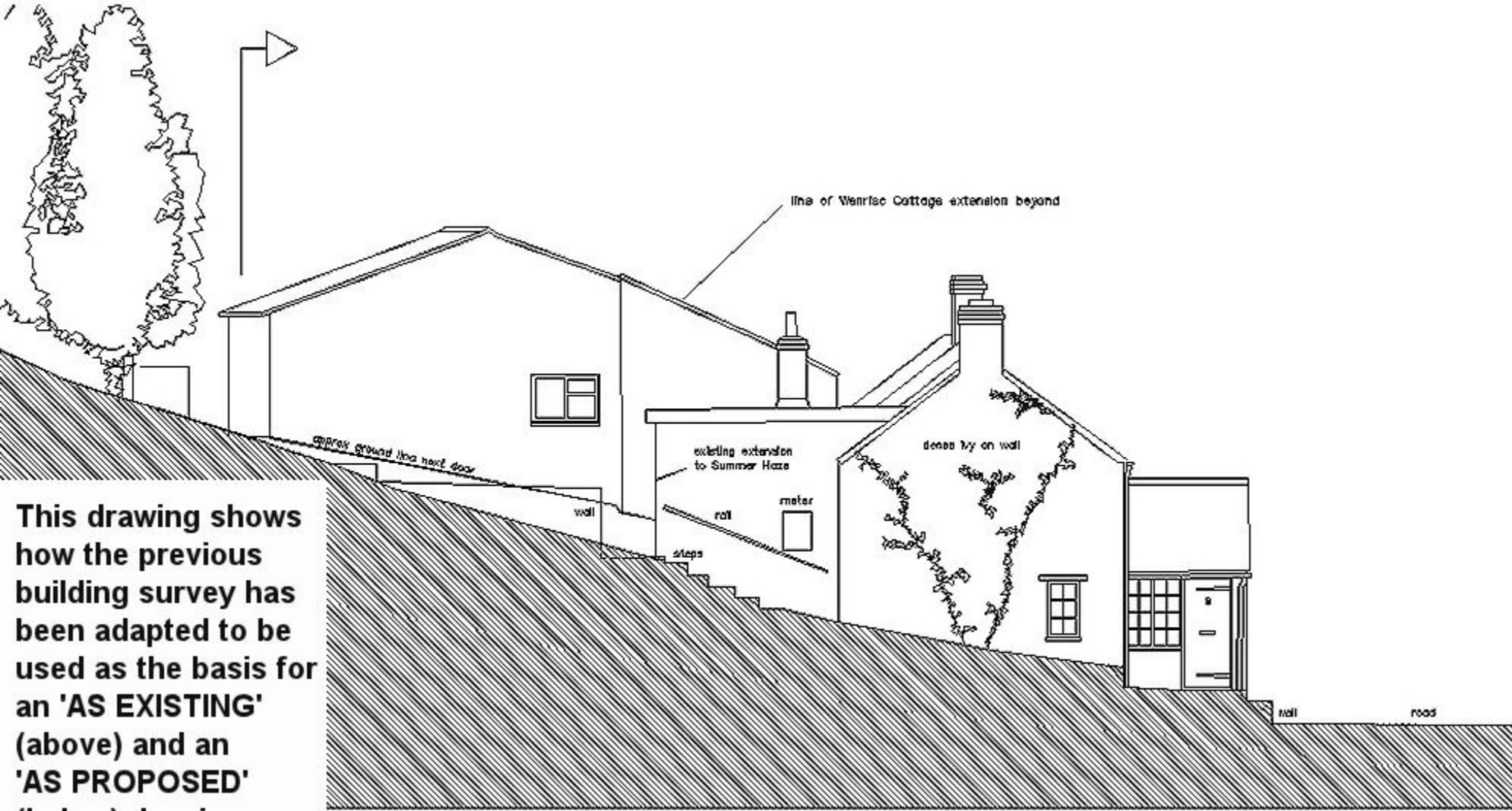

**This drawing shows how the previous building survey has been adapted to be used as the basis for an 'AS EXISTING' (above) and an 'AS PROPOSED' (below) drawing for an extension to a property.**

**This drawing formed part of those required for a Planning Application.**

